

- KEY**
- CPO boundary
 - Noise bund
 - Maintenance access gate
 - 2 way badger gate
- Permanent highway fencing**
- BF - BF - Bat Fence
 - 1.8m close boarded fence
 - BP - BP - 1.2m high timber post and wire fence with badger proofing (HCD/H13 + H46).
 - P&R - Timber post and four rail fence (HCD/H3)
 - ANNB - 1.8m high absorptive noise barrier
 - REH1 - 1.8m high reflective Noise Barrier
 - REH2 - 1.5m high reflective Noise Barrier
- Accommodation works fencing**
- SP - SP - 1.2m high stock proof fence (HCD/H13)
 - SBP - 1.2m high stock/badger proof fence (HCD/H13 + H46)
 - P&W - 1.2m high timber post and wire (HCD13)
- Temporary fencing**
- TF - TF - Temporary Fence (HCD/H1 Type 2)
 - Herptile Fence
 - DIST - 1.8m high temporary Fencing / SSSI Boundary
- Watercourse
 - Track Access
 - Existing Woodland
 - Grass / Planting
 - Wild Flower Dry Mix / Scattered Shrub
 - Wild Flower Wet Mix / Scattered Trees
 - Drainage Pipe Run
 - Drainage Chamber
 - Native Hedgerows with Trees
 - 8m Buffer Zone from Watercourse

Reproduction from the Ordnance Survey Map with the permission of the controller of Her Majesty's stationery office Crown copyright reserved Licence No. AL 100017326

0 10 20 30 40 50 m
 SCALE 1 : 500

R1	10/12/2014	EA ACCESS UPDATED	GWJ	RS
R0	27/05/2014	INITIAL ISSUE	GC	RS
Rev	Rev. Date	Purpose of revision	Drawn	Checked

JACOBS
 Slingson House, 6 Cherry Orchard Road, Croydon, Surrey, CR9 6BE
 Tel: +44(0)208 686 8212 Fax: +44(0) 208 681 2499
 www.jacobs.com

Client: **HOCHTIEF** and **TAYLOR WOODROW**
 Employer: **WATERMILL**

Project: **BEXHILL TO HASTINGS LINK ROAD**

Drawing title: **FDC CONSENT GENERAL ARRANGEMENT WATERMILL**

Drawing status: **ISSUE FOR INFORMATION**

Scale	1:1000 @ A1	DO NOT SCALE
Jacobs No.	B1297000-PH2	
Client no.		

Drawing number	B1297000-Site Sketch 0089 - Watermill	Rev	R1
----------------	---------------------------------------	-----	----

This drawing is not to be used in whole or part other than for the intended purpose and project as defined on this drawing. Refer to the contract for full terms and conditions.

Watermill Cross Section 3-3
 SCALE: H 1:500, V 1:500. DATUM: 0.000

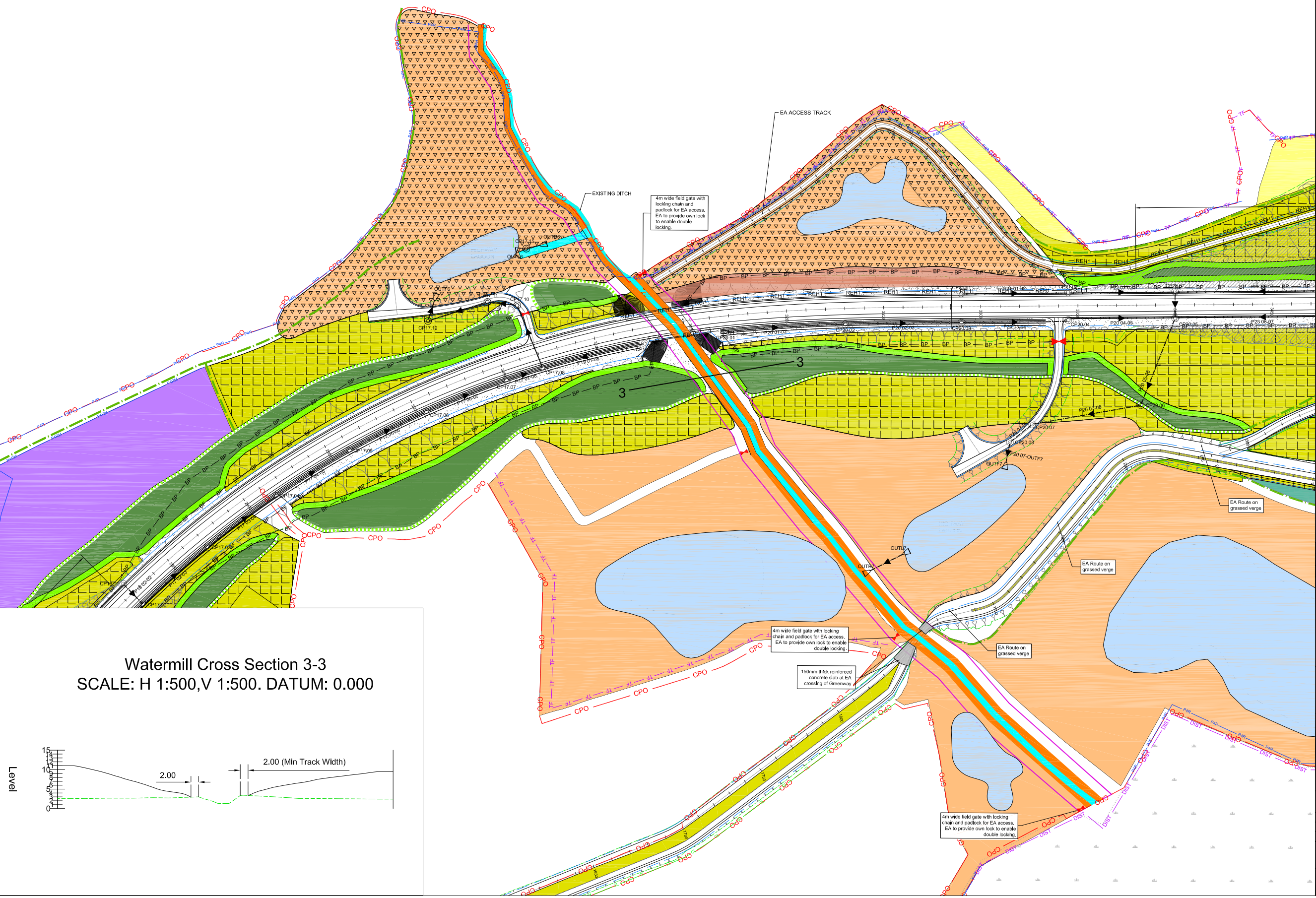
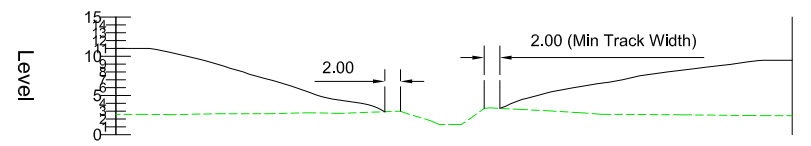

4m wide field gate with locking chain and padlock for EA access. EA to provide own lock to enable double locking

4m wide field gate with locking chain and padlock for EA access. EA to provide own lock to enable double locking

150mm thick reinforced concrete slab at EA crossing of Greenway

4m wide field gate with locking chain and padlock for EA access. EA to provide own lock to enable double locking